

## Lifting Columns • **GAMMA COLONNE**

[> Product](#) > [Technical information](#) > [Product details](#) > [Standard configuration](#) > [Extras](#) > [Available drives](#)

**GAMMA  
COLONNE**

**MULTILIFT  
MULTILIFT S**

### **GAMMA COLONNE – the powerful lifting column**

It is characterised by its compact, sturdy design and its small fitting dimensions. The high-quality linear guidance system guarantees high stability, even when fully extended. GAMMA COLONNE deals with even "heavyweight" adjustment situations with absolutely quiet running and uniform movement.



[> Home](#)

[> Single Drives](#) > [Double Drives](#) > [Control units](#) > [Handsets](#) > [Operating Elements](#) > [Accessories](#) > [Lexicon](#)

# Lifting Columns • GAMMA COLONNE

> Product > **Technical information** > Product details > Standard configuration > Extras > Available drives

GAMMA  
COLONNE  
MULTILIFT  
MULTILIFT S

## GAMMA COLONNE

Front view

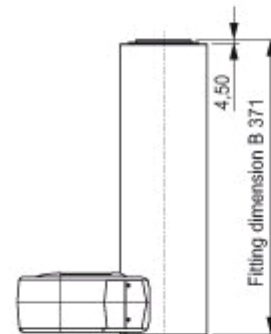

Side view

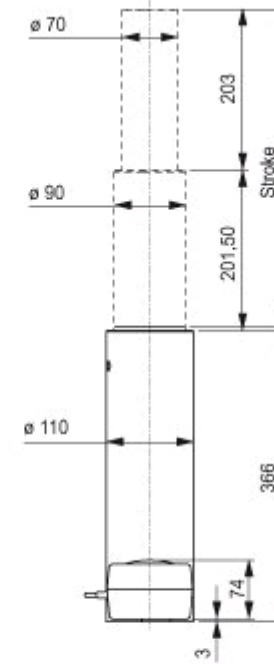

Top view

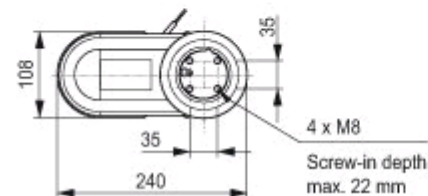

Bottom view  
(with optional base plate)

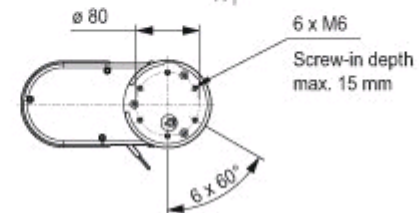

> Home

> Single Drives > Double Drives > Control units > Handsets > Operating Elements > Accessories > Lexicon

# Lifting Columns • **GAMMA COLONNE**

[> Product](#) [> Technical information](#) [> Product details](#) [> Standard configuration](#) [> Extras](#) [> Available drives](#)

GAMMA  
COLONNE  
MULTILIFT  
MULTILIFT S



Fitting sleeve



Fitting sleeve



Wash tunnel proof



[> Home](#)

[> Single Drives](#) [> Double Drives](#) [> Control units](#) [> Handsets](#) [> Operating Elements](#) [> Accessories](#) [> Lexicon](#)

# Lifting Columns • **GAMMA COLONNE**

[> Product](#) [> Technical information](#) [> Product details](#) [> \*\*Standard configuration\*\*](#) [> Extras](#) [> Available drives](#)

**GAMMA  
COLONNE  
MULTILIFT  
MULTILIFT S**

<b>Drive type</b>	lifting column
<b>Protection classification</b>	protection classification III
<b>Protection category</b>	IP 54
<b>Motor voltage</b>	24 V DC
<b>Operating mode</b>	intermittent duty 2/18 min. or operating mode 10%
<b>Type of load</b>	push / pull
<b>Stroke</b>	400 mm
<b>Adjustment load</b>	max. 2000 N as central load max. 1000 N at 400 mm lever arm length
<b>Fitting dimension (B)</b>	371 mm
<b>Colours</b>	grey
<b>Material</b>	anodised aluminium

We reserve the right to make technical alterations!



[> Home](#)

Note: Responsibility for DEWERT products when used for specific applications and for adherence to the appropriate guidelines, standards and laws is borne by the manufacturer of the complete system into which DEWERT products are fitted. We accept no liability for the correctness.

[> Single Drives](#) [> Double Drives](#) [> Control units](#) [> Handsets](#) [> Operating Elements](#) [> Accessories](#) [> Lexicon](#)

# Lifting Columns • **GAMMA COLONNE**

[> Product](#) [> Technical information](#) [> Product details](#) [> Standard configuration](#) **[> Extras](#)** [> Available drives](#)

**GAMMA  
COLONNE**  
**MULTILIFT**  
**MULTILIFT S**

<b>Protection category</b>	IP 66 / wash tunnel proof
<b>Fitting dimension (B)</b>	390 mm with IP 66
<b>Equipment options</b>	memory (potentiometer), base plate for direct screw connection, anti-twist device up to max. 100 Nm
<b>Connection cable</b>	grey, straight, 2000 mm, LSP-plug, PVC grey, straight, 1600 mm, 8-pole DIN-plug, PVC grey, spiralled, 560 mm, LSP-plug, PVC

We reserve the right to make technical alterations!



[> Home](#)

Note: Responsibility for DEWERT products when used for specific applications and for adherence to the appropriate guidelines, standards and laws is borne by the manufacturer of the complete system into which DEWERT products are fitted. We accept no liability for the correctness.

[> Single Drives](#) [> Double Drives](#) [> Control units](#) [> Handsets](#) [> Operating Elements](#) [> Accessories](#) [> Lexicon](#)

# Lifting Columns • **GAMMA COLONNE**

[> Product](#)
[> Technical information](#)
[> Product details](#)
[> Standard configuration](#)
[> Extras](#)
[> Available drives](#)

**GAMMA  
COLONNE**  
  
**MULTILIFT**  
  
**MULTILIFT S**

	Type	GAMMA COLONNE
<b>Max. push / pull force at stroke 0 - 400 mm</b>		2000 / 500 N
<b>Adjustment speed*</b>		up to 12.0 mm/s

\* depending on drive configuration at constant 24 V without load  
We reserve the right to make technical alterations!



[> Home](#)

Note: Responsibility for DEWERT products when used for specific applications and for adherence to the appropriate guidelines, standards and laws is borne by the manufacturer of the complete system into which DEWERT products are fitted. We accept no liability for the correctness.

[> Single Drives](#)
[> Double Drives](#)
[> Control units](#)
[> Handsets](#)
[> Operating Elements](#)
[> Accessories](#)
[> Lexicon](#)

# Lifting Columns • **MULTILIFT**

[> Product](#) > [Technical information](#) > [Product details](#) > [Standard configuration](#) > [Extras](#) > [Available drives](#)

**GAMMA  
COLONNE**

**MULTILIFT  
MULTILIFT S**

## **MULTILIFT – the fully-assembled lifting column**

The slim, elegant design is underlined by the consistent use of aluminium, making it ideal for use in beds and tables.

The powerful linear actuator can deal with an adjustment load of up to 3000 N.



[> Home](#)

[> Single Drives](#) > [Double Drives](#) > [Control units](#) > [Handsets](#) > [Operating Elements](#) > [Accessories](#) > [Lexicon](#)

# Lifting Columns • **MULTILIFT**

> Product > **Technical information** > Product details > Standard configuration > Extras > Available drives

GAMMA  
COLONNE  
MULTILIFT  
MULTILIFT S

## MULTILIFT

Front view

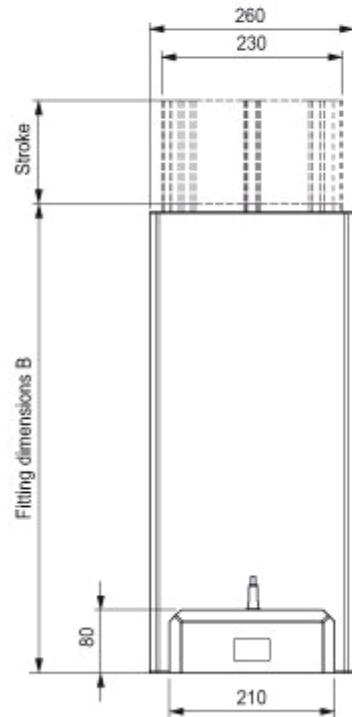

Side view

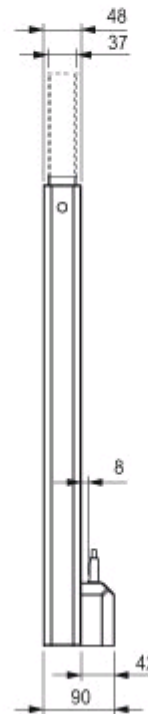

Top view

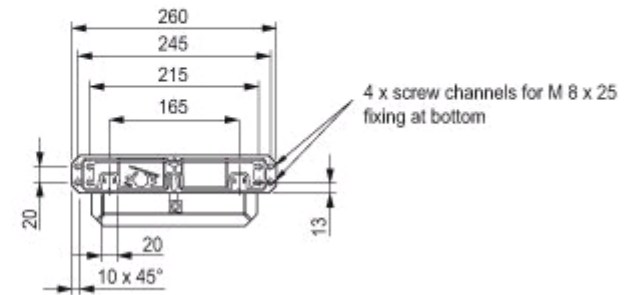

> Home

> Single Drives > Double Drives > Control units > Handsets > Operating Elements > Accessories > Lexicon

# Lifting Columns • **MULTILIFT**

[> Product](#) [> Technical information](#) [> Product details](#) [> Standard configuration](#) [> Extras](#) [> Available drives](#)

GAMMA  
COLONNE  
MULTILIFT  
MULTILIFT S

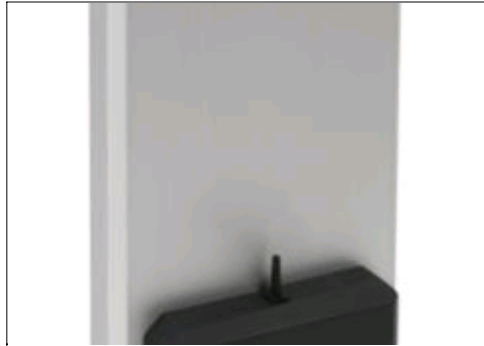

**MULTILIFT without slots**



[> Home](#)

[> Single Drives](#) [> Double Drives](#) [> Control units](#) [> Handsets](#) [> Operating Elements](#) [> Accessories](#) [> Lexicon](#)

# Lifting Columns • **MULTILIFT**

[> Product](#) [> Technical information](#) [> Product details](#) [> Standard configuration](#) [> Extras](#) [> Available drives](#)

**GAMMA  
COLONNE  
MULTILIFT  
MULTILIFT S**

<b>Drive type</b>	lifting column
<b>Protection classification</b>	protection classification III
<b>Protection category</b>	IP 20
<b>Motor voltage</b>	24 V DC
<b>Operating mode</b>	intermittent duty 2/18 min. or operating mode 10%
<b>Type of load</b>	push / pull
<b>Stroke</b>	up to 500 mm
<b>Adjustment load</b>	max. 3000 N
<b>Fitting dimension (B)</b>	195 mm + stroke
<b>Colours</b>	black
<b>Material</b>	anodised aluminium

We reserve the right to make technical alterations!



[> Home](#)

Note: Responsibility for DEWERT products when used for specific applications and for adherence to the appropriate guidelines, standards and laws is borne by the manufacturer of the complete system into which DEWERT products are fitted. We accept no liability for the correctness.

[> Single Drives](#) [> Double Drives](#) [> Control units](#) [> Handsets](#) [> Operating Elements](#) [> Accessories](#) [> Lexicon](#)

# Lifting Columns • **MULTILIFT**

[> Product](#) [> Technical information](#) [> Product details](#) [> Standard configuration](#) **[> Extras](#)** [> Available drives](#)

**GAMMA  
COLONNE  
MULTILIFT  
MULTILIFT S**

**Equipment options**

memory (Hall sensor)

**Connection cable**

black, spiralled, 320 mm, LSP-plug, PVC

We reserve the right to make technical alterations!



[> Home](#)

Note: Responsibility for DEWERT products when used for specific applications and for adherence to the appropriate guidelines, standards and laws is borne by the manufacturer of the complete system into which DEWERT products are fitted. We accept no liability for the correctness.

[> Single Drives](#) [> Double Drives](#) [> Control units](#) [> Handsets](#) [> Operating Elements](#) [> Accessories](#) [> Lexicon](#)

# Lifting Columns • MULTILIFT

[> Product](#)
[> Technical information](#)
[> Product details](#)
[> Standard configuration](#)
[> Extras](#)
[> Available drives](#)

**GAMMA  
COLONNE  
MULTILIFT  
MULTILIFT S**

Type	MULTILIFT 1000	MULTILIFT 3000
<b>Max. push / pull force at stroke 0 - 500 mm</b>	1000 / 1000 N	3000 / 1000 N
<b>Adjustment speed*</b>	up to 16.0 mm/s	up to 8.0 mm/s

\* depending on drive configuration at constant 24 V without load  
We reserve the right to make technical alterations!



[> Home](#)

Note: Responsibility for DEWERT products when used for specific applications and for adherence to the appropriate guidelines, standards and laws is borne by the manufacturer of the complete system into which DEWERT products are fitted. We accept no liability for the correctness.

[> Single Drives](#)
[> Double Drives](#)
[> Control units](#)
[> Handsets](#)
[> Operating Elements](#)
[> Accessories](#)
[> Lexicon](#)

# Lifting Columns • **MULTILIFT S**

[> Product](#) > [Technical information](#) > [Product details](#) > [Standard configuration](#) > [Extras](#) > [Available drives](#)

**GAMMA  
COLONNE**

**MULTILIFT  
MULTILIFT S**

## **MULTILIFT S – the lifting column with minimal fitting dimensions**

MULTILIFT S with incorporated carriage can be used for the continuous height adjustment of equipment, operating units, visual displays etc.

In contrast to the standard MULTILIFT there is not an inner profile which moves out of the lifting column but a carriage which moves inside the column casing. The slots on the carriage make it possible to fit and position any equipment.



[> Home](#)

[> Single Drives](#) > [Double Drives](#) > [Control units](#) > [Handsets](#) > [Operating Elements](#) > [Accessories](#) > [Lexicon](#)

# Lifting Columns • MULTILIFT S

> Product > **Technical information** > Product details > Standard configuration > Extras > Available drives

GAMMA  
COLONNE  
MULTILIFT  
MULTILIFT S

## MULTILIFT S

Front view

Side view

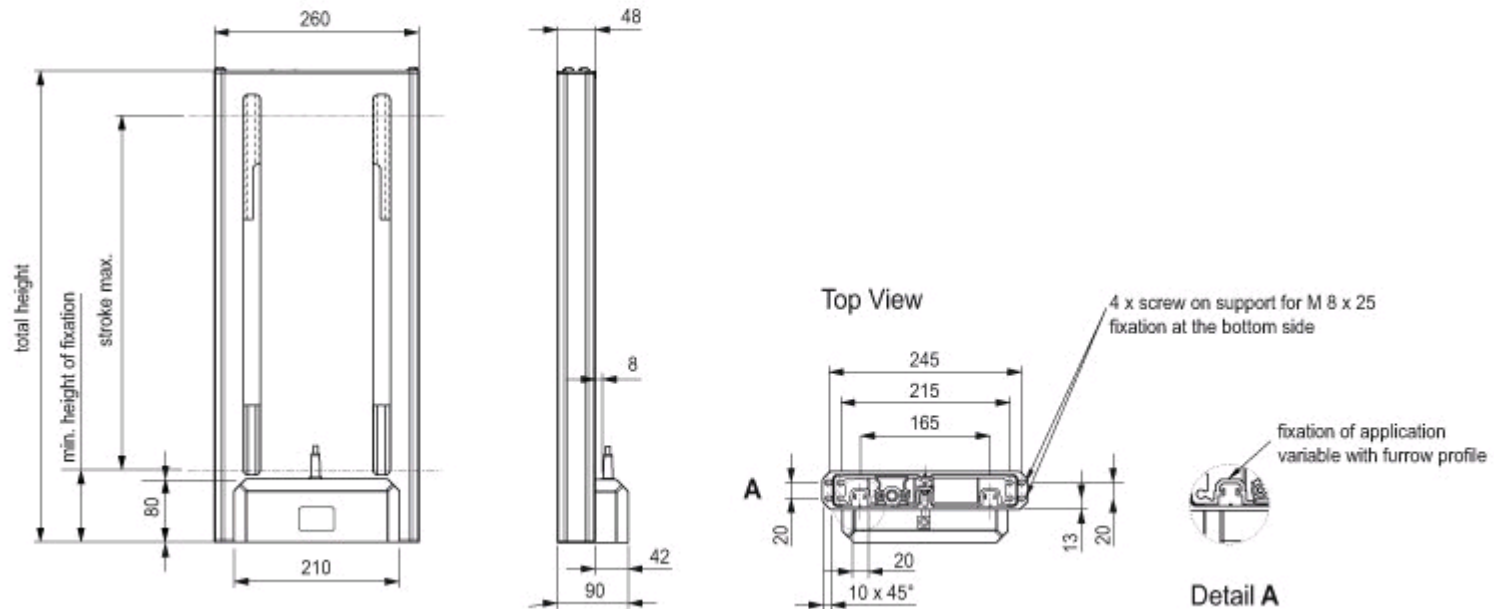

> Home

> Single Drives > Double Drives > Control units > Handsets > Operating Elements > Accessories > Lexicon

# Lifting Columns • **MULTILIFT S**

[> Product](#) [> Technical information](#) [> Product details](#) [> Standard configuration](#) [> Extras](#) [> Available drives](#)

GAMMA  
COLONNE  
MULTILIFT  
MULTILIFT S



**Fitting support**



[> Home](#)

[> Single Drives](#) [> Double Drives](#) [> Control units](#) [> Handsets](#) [> Operating Elements](#) [> Accessories](#) [> Lexicon](#)

# Lifting Columns • MULTILIFT S

[> Product](#) [> Technical information](#) [> Product details](#) [> Standard configuration](#) [> Extras](#) [> Available drives](#)

GAMMA  
COLONNE  
MULTILIFT  
MULTILIFT S

<b>Drive type</b>	lifting column
<b>Protection classification</b>	protection classification III
<b>Protection category</b>	IP 20
<b>Motor voltage</b>	24 V DC
<b>Operating mode</b>	intermittent duty 2/18 min. or operating mode 10%
<b>Type of load</b>	push / pull
<b>Stroke</b>	up to 500 mm
<b>Adjustment load</b>	max. 3000 N
<b>Fitting dimension (B)</b>	approx. 110 mm
<b>Colours</b>	black
<b>Material</b>	anodised aluminium

We reserve the right to make technical alterations!



[> Home](#)

Note: Responsibility for DEWERT products when used for specific applications and for adherence to the appropriate guidelines, standards and laws is borne by the manufacturer of the complete system into which DEWERT products are fitted. We accept no liability for the correctness.

[> Single Drives](#) [> Double Drives](#) [> Control units](#) [> Handsets](#) [> Operating Elements](#) [> Accessories](#) [> Lexicon](#)

# Lifting Columns • **MULTILIFT S**

[> Product](#) [> Technical information](#) [> Product details](#) [> Standard configuration](#) **[> Extras](#)** [> Available drives](#)

**GAMMA  
COLONNE  
MULTILIFT  
MULTILIFT S**

---

**Equipment options**

memory (Hall sensor)

---

---

**Connection cable**

black, spiralled, 320 mm, LSP-plug, PVC

---

We reserve the right to make technical alterations!



[> Home](#)

Note: Responsibility for DEWERT products when used for specific applications and for adherence to the appropriate guidelines, standards and laws is borne by the manufacturer of the complete system into which DEWERT products are fitted. We accept no liability for the correctness.

[> Single Drives](#) [> Double Drives](#) [> Control units](#) [> Handsets](#) [> Operating Elements](#) [> Accessories](#) [> Lexicon](#)

# Lifting Columns • MULTILIFT S

[> Product](#)
[> Technical information](#)
[> Product details](#)
[> Standard configuration](#)
[> Extras](#)
[> Available drives](#)

GAMMA  
COLONNE  
MULTILIFT  
MULTILIFT S

Type	MULTILIFT S 1000	MULTILIFT S 3000
Max. push / pull force at stroke 0 - 500 mm	1000 / 1000 N	3000 / 1000 N
Adjustment speed*	up to 16.0 mm/s	up to 8.0 mm/s

\* depending on drive configuration at constant 24 V without load  
We reserve the right to make technical alterations!



[> Home](#)

Note: Responsibility for DEWERT products when used for specific applications and for adherence to the appropriate guidelines, standards and laws is borne by the manufacturer of the complete system into which DEWERT products are fitted. We accept no liability for the correctness.

[> Single Drives](#)
[> Double Drives](#)
[> Control units](#)
[> Handsets](#)
[> Operating Elements](#)
[> Accessories](#)
[> Lexicon](#)